

HAMPSTEAD INVENTORY HOMES

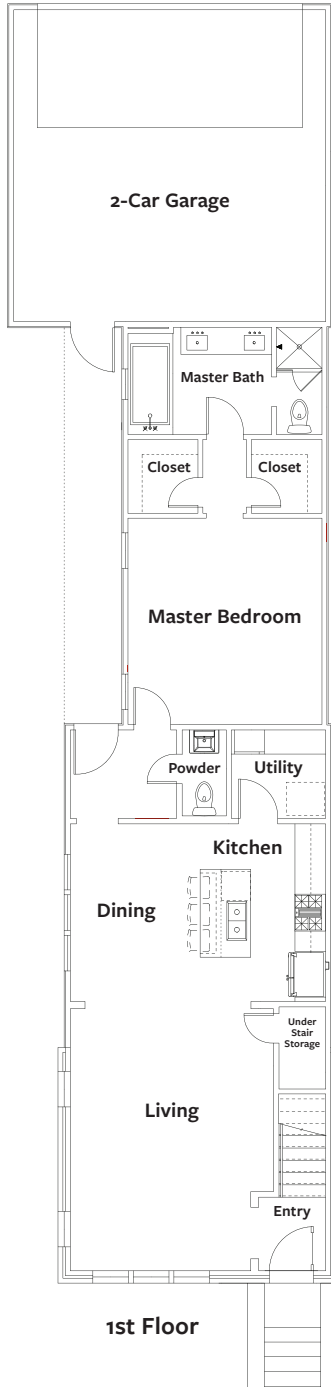

4826 Clerkenwell St.

The Mercer

\$359,900

3 Bedroom, 2.5 Bath
1,860 sq. ft. conditioned approx.
Lot R-8

Features Include:

- Appliances: Stainless Samsung
- Central Bedroom Suite: Ground Floor
- Closets: Two Walk-in Ground Floor Closets
- Countertops: Quartz
- Exterior: Brick, Hardi Siding
- Flooring: Vinyl Wood Flooring, Carpet Upstairs, Tile
- Foundation: Post-Tension
- Insulation: Premium Insulation Package
- Lighting: Premium Light Fixtures
- Parking: 2-Car Garage
- Windows: Pella or WeatherShield Aluminum Lo-E
- Yard: Private Garden Courtyard

Located near Hampstead Farm, the Mercer is a fantastic starter home or an ideal in-town home for those looking to downsize. This open floorplan features sleek interiors selections, stainless Samsung appliances, brick exterior with Hardi siding, and a private fenced courtyard! The master bedroom is located downstairs with 2 spacious bedrooms and a generous sitting area located upstairs. The Mercer plan is one of Hampstead's best sellers!

For more information, visit our Hampstead Sales Home located at 7802 Portman Street.
 334.270.6730 | sales@hampsteadcommunityrealty.com | www.hampsteadliving.com

